



**170 Boundary Road Maldon VIC**

3 1 2

Embrace rural living in this charming three-bedroom circa 1930s period home, nestled on approximately 27.1 acres, just 4 minutes from historic Maldon. This property has the quintessential Australian landscape with a bush setting, rolling terrain, a picturesque dam and a Shiraz vineyard, offering a serene escape surrounded by nature.

The beautifully renovated home features an open-plan living and dining space. Large double-hung windows frame stunning bush views, reminiscent of a Frederick McCubbin painting. The space provides comfort with a solid wood heater inset into a period timber surround and a reverse cycle air conditioner for those warmer months. The contemporary country-style kitchen that overlooks the enclosed vegetable and herb garden provides a 110cm

**Type** : House  
**Price** : \$965,000  
**Building Size** : 104 sqm  
**Land Size** : 27.1 Acres  
**View** : <https://www.cantwellproperty.com.au/sale/vic/greater-bendigo-region/maldon/residential/house/8170352>



**Tom Robertson**  
03 5472 1122



**Megan Walmsley**  
03 5472 1122

[For full version visit the website](https://www.cantwellproperty.com.au)

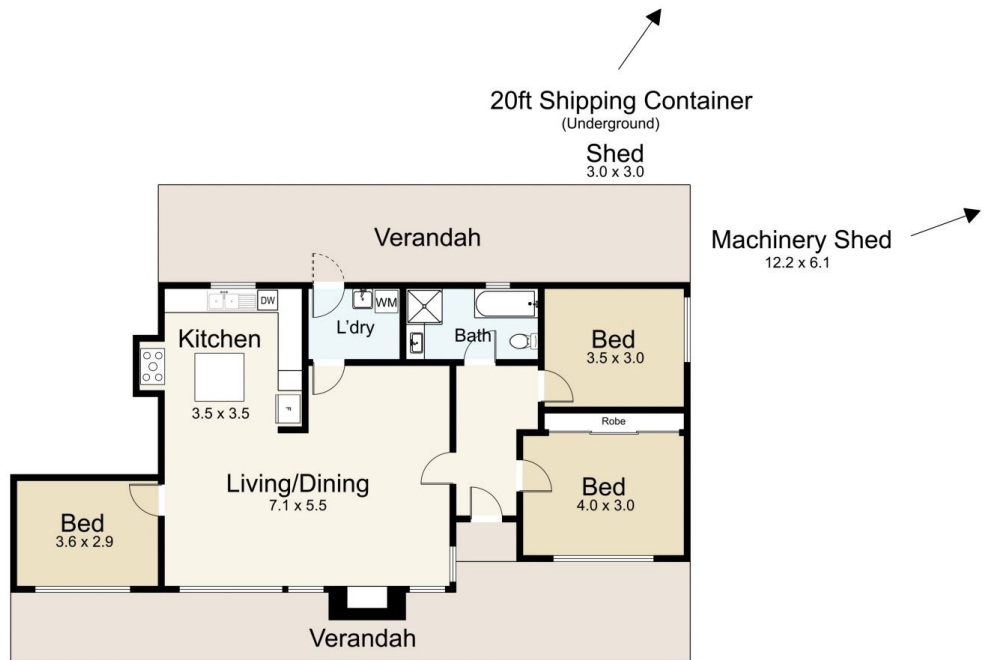
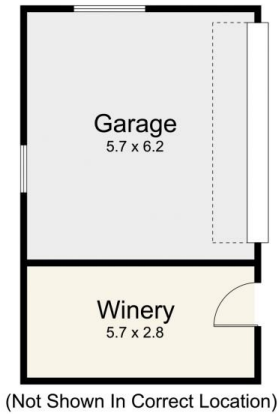

## 170 Boundary Road, Maldon

SCALE UNIT IS IN METRES  
All measurements are approximate and for illustration purposes only. It should not be considered 100% accurate. Interested parties should rely on their own enquiries.

Residence - 104m<sup>2</sup>  
Garage/Winery - 51m<sup>2</sup>

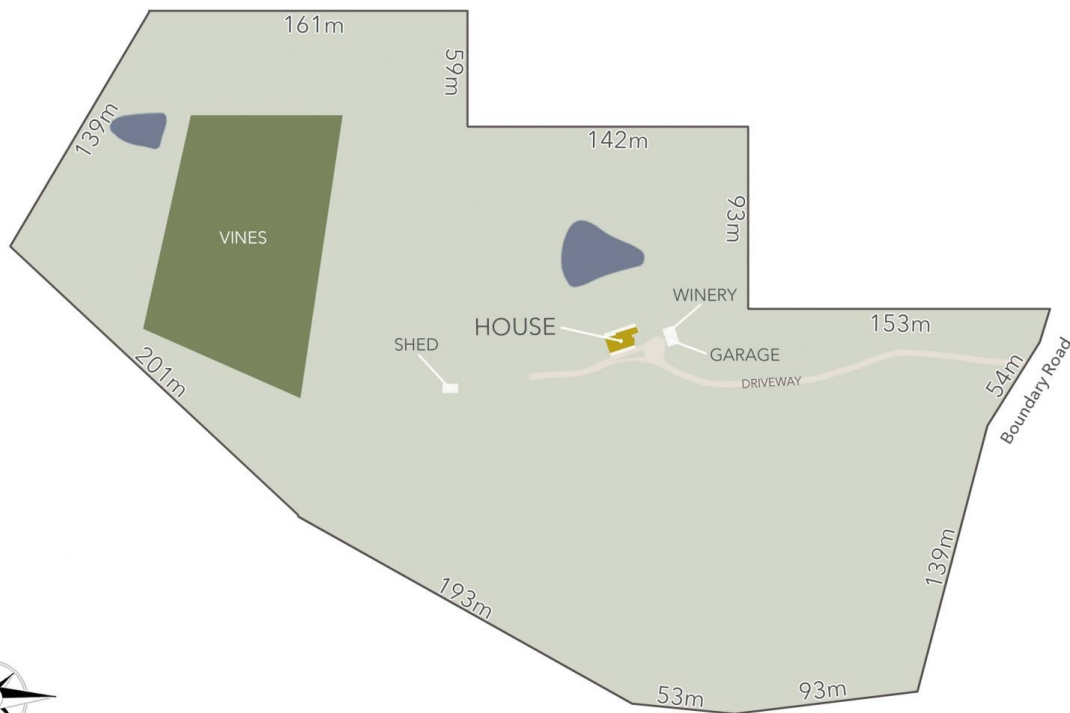

LAND AREA : 27.1Ac (APPROX)



## 170 Boundary Road, Maldon

All Measurements & Details Shown Are Approximate Only.